

Essential safety measures

ESMs act as a first line of defence in the event of a fire.

Essential Safety Measures (ESMs) are safety features required for a building or place of public entertainment to protect occupants in case of a fire.

Non-compliance of ESMs not only puts occupants at risk, but also passers-by and adjoining buildings.

Maintained ESMs can provide occupants with more time to exit the building and lessen the chance of fire spreading. The maintenance of ESMs and keeping exits and pathways clear are the owners' responsibility.

Annual ESM reports must be made available for inspection on request after 24 hours' notice has been

given by the fire brigade's chief officer or your municipal building surveyor. Auditors will be checking these Annual ESM reports as part of the Statewide Cladding Audit.

Owners need to make sure that ESM maintenance and inspection (including repairs) are carried out, and that records are made available. If they are not, owners could be fined.

An infringement notice can be issued by your Council or the Fire Authority. Fines can amount to **over \$35,000 for an individual** and over \$245,000 for companies prosecuted.*

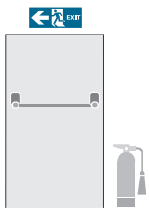

ESMs include exit doors, emergency lighting, exit signs and fire hydrants

Maintenance of ESMs helps ensure reliability in an emergency



Owners are responsible for ensuring ESMs are maintained and operational

Non-compliance puts occupants, passers-by and adjoining buildings at risk



Annual ESM reports will be checked by auditors as part of the Statewide Cladding Audit

Non-compliance may result in fines



*The value of one penalty unit for 2019–20 is \$165.22. Fines can be up to 240 penalty units for individuals and 1500 penalty units for companies.